

IRONHORSE PARCEL C

BEING A REPLAT OF A PORTION OF THE GOLF COURSE AND ALL OF PARCEL "C", IRONHORSE, AS RECORDED IN PLAT BOOK 65, PAGES 191 THROUGH 206, PUBLIC RECORDS OF PALM BEACH COUNTY, FLORIDA, LYING IN SECTION 22, TOWNSHIP 42 SOUTH, RANGE 42 EAST, CITY OF WEST PALM BEACH, PALM BEACH COUNTY, FLORIDA
SEPTEMBER 1994
SHEET 2 OF 3

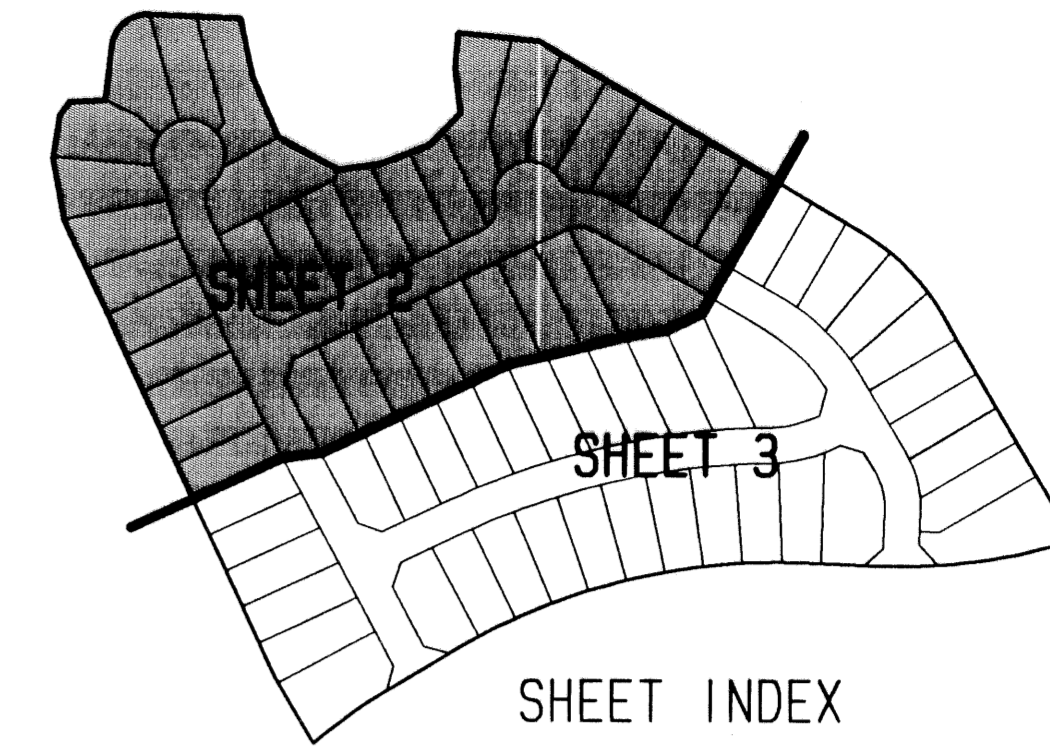
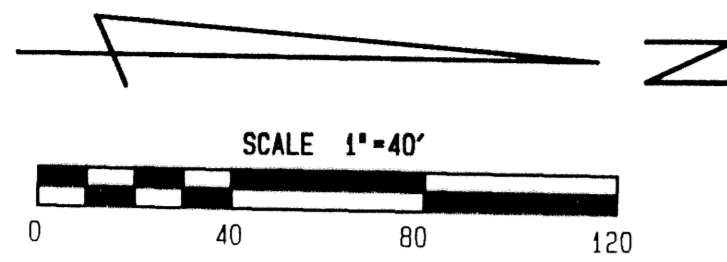

78

COUNTY OF PALM BEACH
STATE OF FLORIDA
This Plat was filed for record at _____
this _____ day of _____
19____ and duly recorded in Plat Book No. _____
on page _____
JOHN B. DUNKLE, Clerk Circuit Court
By _____ D. C.



NOTES

- Bearings shown hereon are in the meridian of IRONHORSE, as recorded in Plat Book 65, Pages 191 through 206, Public Record of Palm Beach County, Florida, resulting in a bearing of South 64°56'33" West along the Southeasterly line of PARCEL C.
- The building setbacks shall conform to City of West Palm Beach zoning code.
- No building or any kind of construction shall be placed on utility or drainage easements.
- No structures, trees or shrubs shall be placed on drainage easements.
- Approval of landscaping on utility easements other than water or sewer shall be only with approval of all utilities occupying same.
- When drainage and utility easements cross, drainage easements shall take precedence.
- There may be additional restrictions that are not recorded on this Plat that may be found in the Public Records of this County.
- All lot lines are non-radial unless otherwise noted.
- There shall be no buildings, structures, construction of any kind, trees or shrubs placed on water management easements or water management maintenance easements, as shown thereon, unless approved, in permit form, at the Northern Palm Beach County Water Control District.

SUBDIVISION Ironhorse Parcel C
BOOK 74 PAGE 78
FLOOD ZONE FLOOD MAP
QUAD ZONING
SE ZIP CODE
PUD NAME CWB

LEGEND

□	= PERMANENT REFERENCE MONUMENT
○	= PERMANENT CONTROL POINT #4676
P. O. B.	= POINT OF BEGINNING
R	= RADIUS
A	= LENGTH OF ARC
Δ	= CENTRAL ANGLE
P. B.	= PLAT BOOK
Pp.	= PAGES
(RAD)	= RADIAL
U. E.	= UTILITY EASEMENT
D. E.	= DRAINAGE EASEMENT
IEE	= INGRESS-EGRESS EASEMENT
NPBCWD	= NORTHERN PALM BEACH COUNTY WATER CONTROL DISTRICT
RME	= RECIPROCAL MAINTENANCE EASEMENT

MOCK, ROOS & ASSOCIATES, INC.
5720 CORPORATE WAY, WEST PALM BEACH, FL 33407 (407) 683-3113

SCALE: 1" = 40' DATE: MARCH 1994
P. A. NO. 9318B.00 CAD FILE: IRONRPO1

IRONHORSE PARCEL C
REPLAT OF TRACT 'C'
SECTION 22; TOWNSHIP 42 SOUTH; RANGE 42 EAST.

SHEET 2 OF 3